

PRICE 25 CENTS

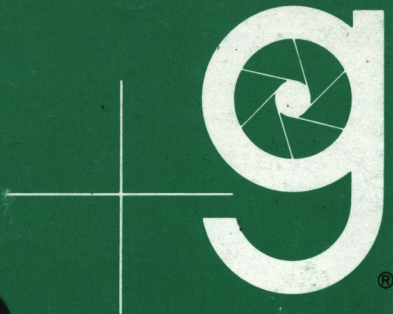
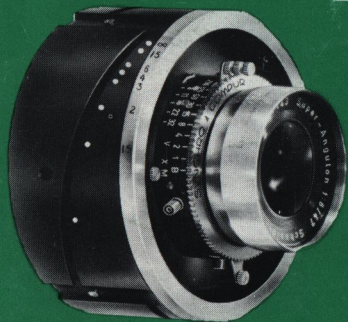

xl Lens and Barrel Guidebook

graflex[®]xl
camera systems

Your new xl lens and barrel plays a very important part in the most exciting new design idea in photography . . . most practical, too!

The Graflex xl Camera Systems.

The first complete and fully flexible system of cameras, lenses, backs and accessories. A unique system that lets you build a personal-style camera you can work with easily, efficiently and successfully.

Brilliantly designed and precision-built, the xl lens and barrel features a between-the-lens shutter, highly-corrected high resolution lenses, a cam and precision-matched barrel. An easy-to-handle, one-piece unit, the lens and barrel

slips smoothly and easily into the xl camera bayonet mount and focusing ring. With the xl camera, it forms a rigid, exactly-integrated camera-lens system.

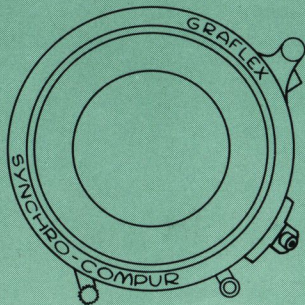

Attaching lens to xl camera body

1. Lenses attach to xl camera bayonet mount and focusing ring. Simply rotate the focusing ring counterclockwise until it stops. Depress the release button on the front of the camera body—freeing the focusing ring. Continue to rotate the ring until the interior guides align.

2. To insert the barrel, line up the red dot on the lens-and-barrel unit with the white dot on the focusing ring. In this position, lower the barrel into the focusing ring mount. Gently force the barrel in as far as it will go.

3. Once the barrel is placed in the mount, turn the focusing ring clockwise to secure it. As you turn the ring, you will hear a click. This sound indicates that the barrel is firmly in place on the interior guides of the focusing ring. Continue to rotate the focusing ring clockwise until pressure tells you it will go no farther. The lens is now in the infinity focus position.

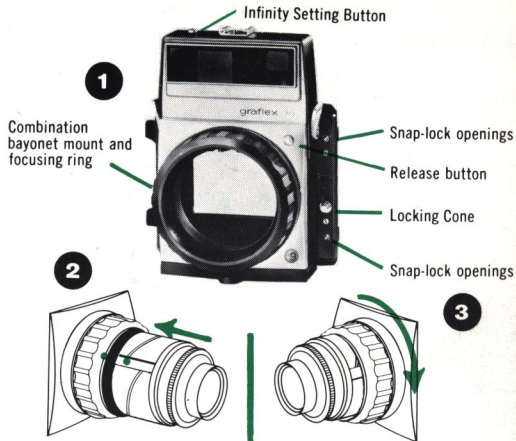

Synchronizing lens with rangefinder on the xl

With the lens set at infinity, press down on the precision-sync infinity setting button—at top of camera body. This gives you perfect synchronization between the rangefinder and the mounted lens—throughout the entire focusing range of the lens. And it eliminates the variations incurred within normal camera manufacturing tolerances.

Lens: 47mm Schneider Super Angulon f/8 lens, extreme wide angle.

Shutter: MXV-00 SYNCHRO-COMPUR with 1/500 top speed.

SHUTTER SPEED: Knurled ring (1). Rotate until red index mark on knurled ring indicates desired speed setting. Read from top of shutter.

COCKING: Lever (2). Move as illustrated.

TRIP: Lever (3). Press inward toward shutter.

B Setting: Shutter remains open as long as trip lever is held depressed toward shutter. Use locking type cable release for time exposures.

PRESS FOCUS: None. To focus on the ground glass, set shutter speed at B and use a locking type cable release. Cock the shutter and trip through the cable release using the locking feature of the cable release to hold shutter open.

DIAPHRAGM SETTING. Lever (4). Move lever until index line on lever is pointing to desired f-number. Lever may be moved from bottom of shutter also.

CABLE RELEASE: Threaded boss (5). Use tapered tip cable release.

FLASH CONNECTION: Terminal post (6). Attach a Graflite® connecting cord with a DIN or PC fitting.

SYNCHRONIZATION:

Electronic Flash—Lever (7). Move to set indicator pointer at X on scale (8).

M2 Bulbs—Lever (7). Move to set indicator at X on scale (8). Use shutter speeds 1/30 sec. or slower.

AG-1, M5 and Type M Bulbs—Lever (7). Move to set indicator pointer at M on scale (8). All speeds are synchronized.

SELF TIMER: Cock shutter (2). Move lever 7 down to set indicator at V on scale (8). Trip shutter, lever (3). Shutter will open automatically in 8 - 12 sec. Flash synchronization will be the same as at the X setting.

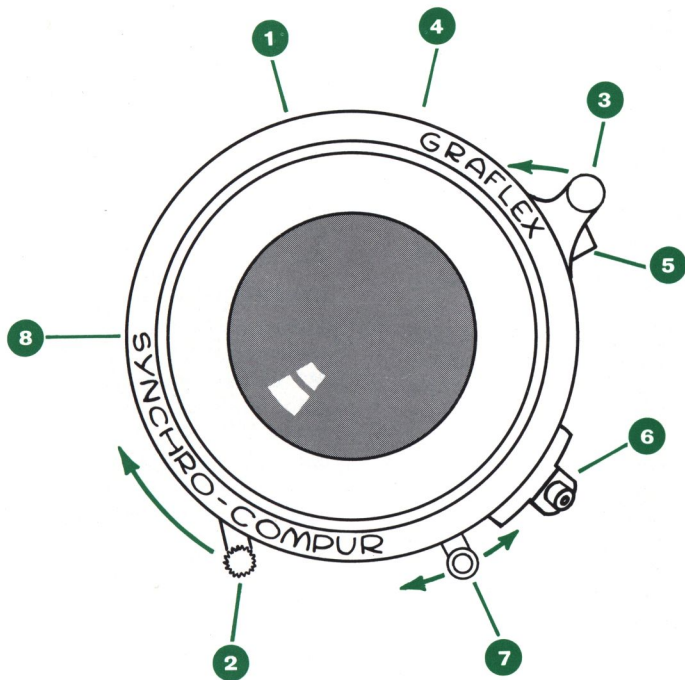

Lens: 58mm Rodenstock Grandagon f/5.6 lens, extreme wide angle.

Shutter: MXV-00 SYNCHRO-COMPUR with 1/500 top speed.

SHUTTER SPEED: Lever (1). Click stop action, move lever until index at top of shutter is aligned to desired speed setting on the speed scale (2).

COCKING: Lever (3). Move as illustrated.

TRIPPING: Lever (4). Press inward toward shutter.

B Setting: Shutter remains open as long as trip lever is depressed toward shutter. Use a locking type cable release for time exposures.

PRESS FOCUS: None. To focus on the ground glass, set shutter speed at B and use a locking type cable release. Cock the shutter and trip through the cable release using the locking feature of the cable release to hold shutter open.

DIAPHRAGM SETTING: Lever (5). Move lever until index line on lever is pointing to desired f-number.

CABLE RELEASE: Cable support (6) at-

tached to the circular mount. Use tapered tip cable release.

FLASH CONNECTION: Angled terminal post (7). Attach a Graflite® connecting cord with a DIN or PC fitting.

SYNCHRONIZATION:

Electronic Flash—Lever (8). Move to set indicator at X on scale (9).

M2 Bulbs—Lever (8). Move to set indicator at X on scale (9). Use shutter speed 1/30 sec. or slower.

AG-1, M5 and Type M Bulbs—Lever (8). Move lever to set indicator at M on scale (9). All speeds are synchronized.

SELF TIMER: Cock shutter, lever (3). Move lever (8) to set indicator at V on scale (9). Trip shutter lever (4). Shutter will open automatically in 8 - 12 sec. Flash synchronization will be the same as at the X setting.

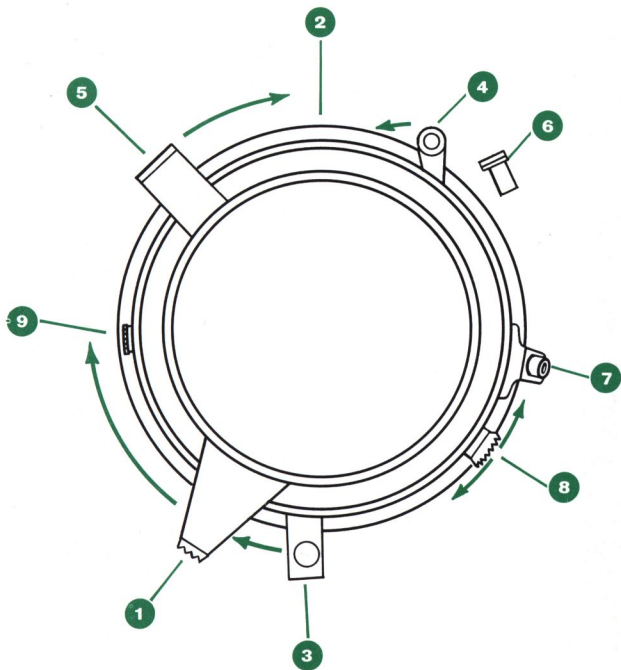

Lens: 95mm Rodenstock Ysarex f/3.5 lens; 100mm Zeiss Tessar f/3.5 Lens.

Shutter: MXV-O SYNCHRO-COMPUR with 1/500 top speed.

SHUTTER SPEED: Knurled ring (1). Click stop action, rotate until index arrow on knurled ring indicates desired speed setting.

COCKING: Lever (2). Move as illustrated.

TRIPPING: Lever (3). Press inward toward shutter.

B Setting—Shutter remains open as long as trip lever is depressed toward shutter.

PRESS FOCUS:

Open—Press focus Lever (4) all the way to the end.

Close—Press focus Lever (4) all the way back.

DO NOT TRIP SHUTTER WITH PRESS FOCUS LEVER IN OPEN POSITION.

DIAPHRAGM SETTING: Lever (5). Click

stop action. Move lever until red arrow on lever is pointing to desired f-number.

CABLE RELEASE: Threaded boss (6). Use tapered tip cable release.

FLASH CONNECTION: Angled terminal post (7). Attach a Graflite® connecting cord with DIN or PC fitting.

SYNCHRONIZATION:

Electronic Flash—Lever (8). Set at X.

M2 Bulbs—Lever (8). Set at X. Use shutter speeds of 1/30 sec. or slower.

AG-1, M5 and Type M Bulbs—Lever (8). Set at M. All speeds are synchronized.

SELF-TIMER: Cock shutter, lever (2). Place lever (8) at V. Trip shutter, lever (3). The shutter will open automatically in 8 - 12 sec. Flash synchronization will be the same as at the X setting.

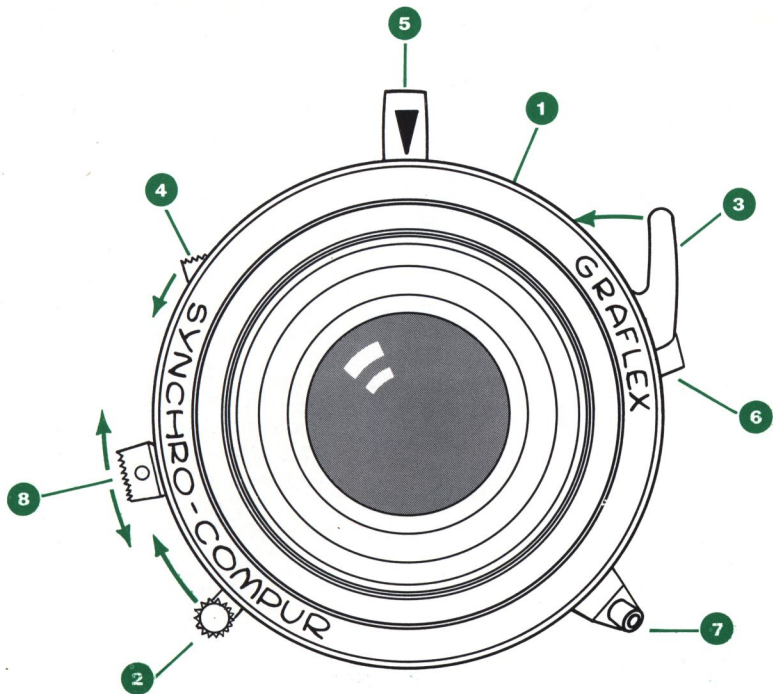

Lens: 80mm Zeiss Planar f/2.8 lens; 95mm Rodenstock Heligon f/2.8 lens; 100mm Zeiss Planar f/2.8 lens.

Shutter: MX-1 SYNCHRO-COMPUR SHUTTER with 1/400 top speed, self-timer, DIN fitting.

SHUTTER SPEED: Knurled ring (1). Click stop action, rotate ring until desired speed setting is opposite index mark. Double scales and indices permit reading from top or face of shutter.

COCKING: Lever (2). Move as illustrated.

TRIPPING: Lever (3). Press inward toward shutter.

B Setting—Shutter remains open as long as trip lever is held depressed.

T Setting—Shutter remains open when trip lever is depressed. Will remain open until trip lever is depressed a second time.

PRESS FOCUS:

Cock—Lever (2)

Open—Press in focus button (4).

Close—Lift out press focus button (4).

DIAPHRAGM SETTING: Lever (5). Move lever to desired f-number. Double scales and indices permit reading from face or

side of shutter. If read from side, desired diaphragm setting should be set to notch.

CABLE RELEASE: Threaded boss (6). Use tapered tip cable release.

FLASH CONNECTION: Right angle terminal post (7). Attach a Graflite® Connecting Cord with DIN or PC fitting.

SYNCHRONIZATION:

Electronic Flash—Lever (8). Set at X.

M2 Bulbs—Lever (8). Set at X. Use shutter speeds of 1/30 sec. or slower.

AG-1, M5 and Type M Bulbs—Lever (8). Set at M. All speeds are synchronized.

SELF TIMER: Cock shutter, lever (2). Self timer button (9). Push back self-timer button (9) and continue shutter cocking. Trip shutter lever (3). The shutter will open automatically in 8 - 12 sec. Flash synchronization will be the same as at the X setting.

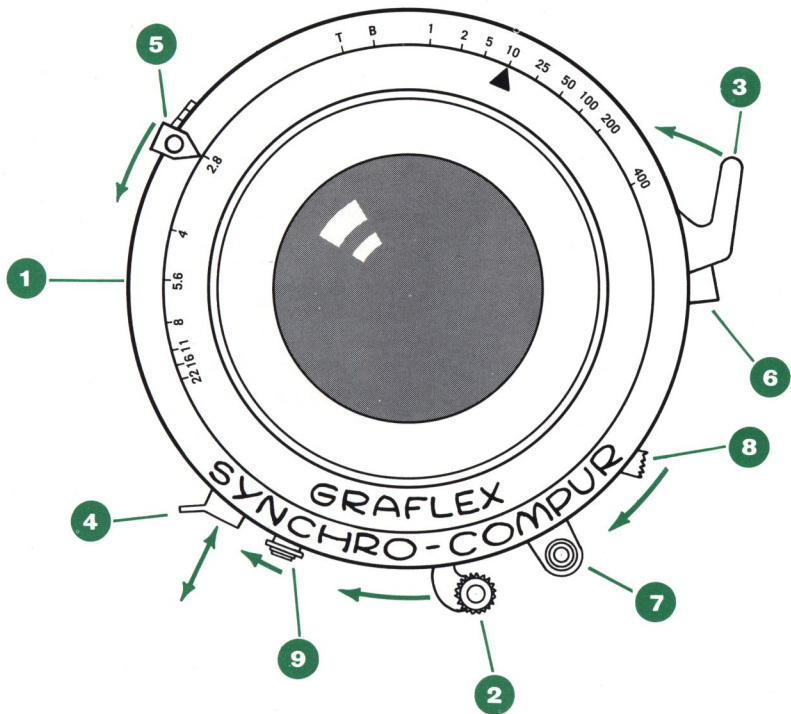

Lens: 180mm Zeiss Sonar f/4.8 lens

Shutter: MXV-O SYNCHRO-COMPUR with 1/400 top speed.

SHUTTER SPEED: Speed setting ring (1). Click stop action. Rotate speed ring to locate desired speed setting opposite index mark on lens.

COCKING: Lever (2). Move full left.

TRIPPING: Lever (3). Press left toward diaphragm setting window.

B Setting—Shutter remains open as long as a trip lever is depressed.

PRESS FOCUS:

Open—Press focus lever (4) downward past center detent.

Close—Raise focus lever (4) upward past center detent.

DIAPHRAGM SETTING: Lever (5). Click stop action. Movement of lever changes f number in diaphragm setting window at top of shutter.

CABLE RELEASE: Threaded boss (6). Use tapered tip cable release.

FLASH CONNECTION: Angled boss (7). Attach Graflite® connecting cord with DIN fitting.

SYNCHRONIZATION:

Electronic Flash—Lever (8). Set at X.

M2 Bulbs—Lever (8). Set at X. Use shutter speeds of 1/30 sec. or slower.

M5 and Type M Bulbs—Lever (8). Set at M. All speeds are synchronized.

SELF TIMER: Lever (8). Same as sync lever. Cock shutter, lever (2). Place lever (8) in V position. Trip shutter, lever (3). The shutter will open automatically in 8-12 sec. Flash synchronization will be the same as at the X setting.

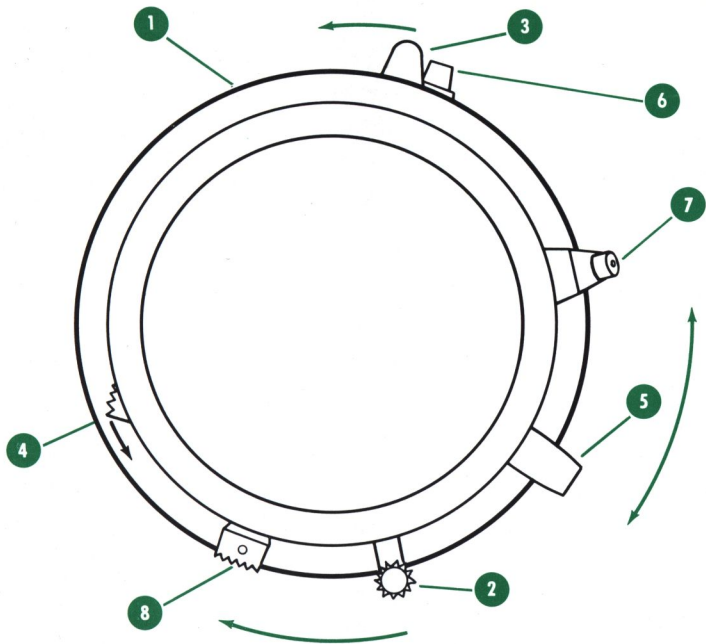

YOUR GRAFLEX WARRANTY:

To the initial retail purchaser of Graflex merchandise:

Skilled craftsmen have produced the Graflex merchandise you have purchased. They have built into it a level of quality and performance which will insure your enjoyment of its use.

Graflex merchandise is warranted by Graflex and the Graflex Dealer from whom you purchased the same, to be free from faulty materials and workmanship, except as hereinafter set forth. If any time during your first year of ownership, (90 days in the case of any electronic components and parts, including without limitation, tubes and projection lamps), any servicing is necessitated by faulty material or workmanship, it will be provided (or the equipment replaced at our option) without charge except for transportation charges by your nearest Graflex Service facility. Returns for servicing should be made through your Graflex Dealer; or if this is not convenient, the merchandise should be carefully packed in a stiff container with adequate packing (not excelsior). Attach name and address and any *specific instructions* to the package, which should be adequately secured and fully insured.

THIS WARRANTY IS NOT APPLICABLE:

- A. To Graflex merchandise which in our judgment has been damaged, abused, or requires replacement of parts due to wear and tear from use, or for any reason other than faulty materials and workmanship. Such merchandise will be serviced at factory-established rates.
- B. To Graflex merchandise which has been tampered with or serviced by persons other than Graflex approved personnel.
- C. If adaptations or accessories of other than Graflex recommendations have been made or attached.
- D. Where the Graflex merchandise bears serial numbers, if it has not been registered with Graflex by means of the attached registration card or appropriate substitute within 60 days from date of purchase.

No liability is assumed for film which is damaged or is unsatisfactory for any reason (due to equipment malfunction or otherwise), nor is Graflex, Inc., obligated to replace such film.

EXCEPT AS EXPRESSLY SET FORTH HEREIN NO OTHER WARRANTIES ARE MADE BY GRAFLEX OR YOUR GRAFLEX DEALER WITH RESPECT TO GRAFLEX MERCHANDISE, INCLUDING, WITHOUT LIMITATION, WARRANTIES AS TO FITNESS FOR A PARTICULAR PURPOSE AND OF MERCHANTABILITY. No liability is assumed for expenses or damages resulting from interruptions in operation of equipment, nor for incidental or consequential damages of any nature.

In order that we may be able to pursue our continuing program of product improvement, Graflex reserves the right to make changes in design, or add improvements to any product without incurring any obligation to include such revisions in equipment previously produced.

The warranties hereinbefore expressly set forth are made only to the *original retail purchaser*. Graflex's liability under the within warranty is limited to repair or replacement as hereinbefore provided.

SERVICE FACILITIES:

Graflex Approved Service Stations are conveniently located in all major cities. Contact your Graflex Dealer or write to the Manager, Graflex Service Sales, for the address of the Graflex Approved Service Station nearest you.

Record below such serial numbers as your equipment bears for your insurance file and future reference.

Serial Nos.....

GRAFLEX, INC., Rochester, N. Y. 14603

graflex® xl

camera systems

Home Office:

3750 Monroe Avenue
Rochester, New York 14603

Western Division:

800 North Cole Avenue
Hollywood, California 90038

Midwest Service Department:

1345 Diversey Parkway
Chicago, Illinois 60614

Graflex of Canada Limited:

47 Simcoe Street
Toronto 1, Ontario, Canada



GRAFLEX, Inc.

Rochester, New York
14603, U.S.A.

A subsidiary of
General Precision
Equipment Corporation