

# TELEPHOTO NIKKOR LENSES

Telephoto or long focus lenses have a longer focal length and provide a larger image magnification than normal or wideangle lenses. These lenses give a close-up image of distant subjects and are advantageous in long-distance camera-subject situations.

Another characteristic of this type of lens is the apparent flattening effect of subjects in the final print. This results in a distant subject appearing to move forward toward a closer subject when both subjects are in focus. In contrast with wideangle lenses, telephoto lenses cover a smaller field of view and a shallower depth of field. Because of this shallow depth, the picture appears relief-like due to a lack of sharpness in out-of-focus areas. Nikkor telephoto lenses are excellent for a variety of photographic assignments—news, sports, theater, nature, etc.

The f/1.8 aperture of this lens is the largest among Nikkor telephoto lenses. It facilitates easy focusing under poor light conditions and is especially suited for indoor and night photography.

The "moderately" long 85mm focal length provides proper image magnification and natural perspective, making the lens ideal for portraiture, theatrical photography and photojournalism.

The lens has high resolution and outstanding contrast even at full lens opening.

Its symmetrical-type design ensures satisfactory results in close-up photography as well.

Focal length:	85mm
Maximum aperture:	1 : 1.8
Lens construction:	6 elements in 4 groups
Picture angle:	28°30'
Distance scale:	Graduated both in meters and feet up to 1m and 3.5ft
Aperture scale:	f/1.8 — f/22
Aperture diaphragm:	Fully automatic
Meter coupling prong:	Integrated (fully open exposure metering)
Attachment size:	52mm (P=0.75)
Filter:	52mm screw-in
Dimensions:	72mm dia. X 70mm length (2-27/32 in. X 2-3/4 in.)
Weight:	420g (14.8oz)
Accessories:	52mm snap-on front cap (108-00-400), rear cap type F (108-00-401), 52mm screw-in lens hood (108-02-201), leather case (108-02-304), plastic case type S (108-00-300), flexible pouch No. 52 (108-02-302)

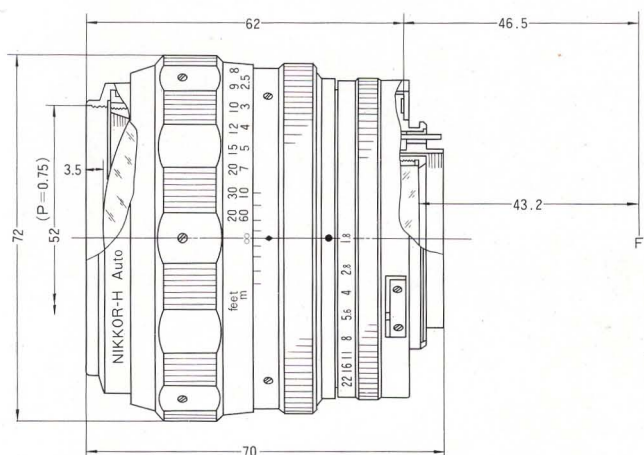
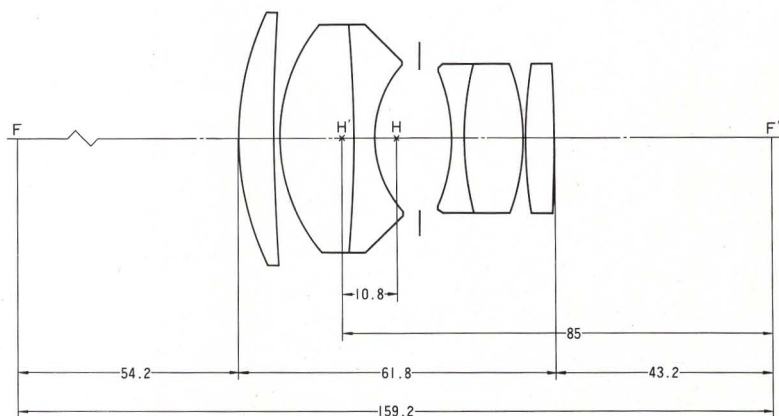

(m/m)



The new 105mm f/2.5 Nikkor-P Auto lens has the same brightness and focal length as the conventional 105mm lens. With a focal length that comes midway between those of 85mm and 135mm Nikkor Auto lenses, this lens is the most suitable choice for photographers using a telephoto lens for the first time. Hence, most of the Nikon camera owners have a 105mm telephoto lens in their equipment inventory. Compared with normal lenses, this lens has a focal length about twice as long and a picture angle about half as wide. This enables the photographer to take pictures in greater natural perspective, an important feature for portraiture, etc.

A high speed of f/2.5 despite its long focal length and the excellent sharpness of the image in focus with flares reduced to a minimum make this lens indispensable for indoor sports coverage or stage photography.

Focal length:	105mm
Maximum aperture:	1 : 2.5
Lens construction:	5 elements in 4 groups
Picture angle:	23°20'
Distance scale:	Graduated both in meters and feet up to 1m and 3.5ft
Aperture scale:	f/2.5 — f/32
Aperture diaphragm:	Fully automatic
Meter coupling prong:	Integrated (fully open exposure metering)
Attachment size:	52mm (P=0.75)
Filter:	52mm screw-in
Dimensions:	66mm dia. X 78mm length (2-19/32 in. X 3-1/16 in.)
Weight:	435g (15.3oz)
Accessories:	52mm snap-on front cap (108-00-400), 52mm snap-on lens hood (108-02-202), rear cap type F (108-00-401), 52mm screw-in lens hood (108-02-200), leather case CL-9 (108-02-304), plastic case type L (108-02-300), flexible pouch No 52 (108-02-302)

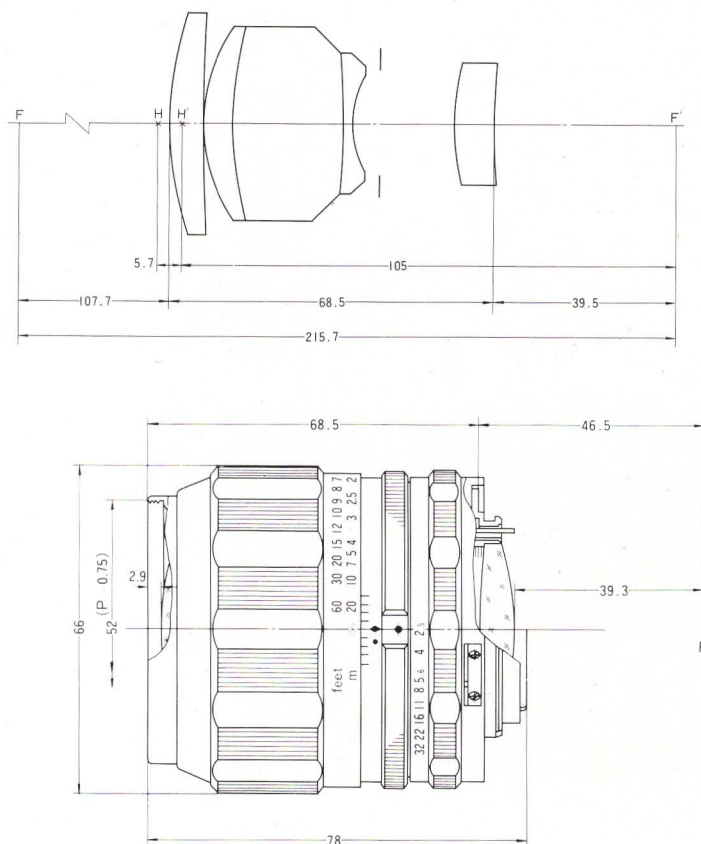

(m/m)

With a large aperture of f/2.8, this 135mm telephoto lens is well corrected for all aberrations and produces excellent resolution and high contrast even at full lens opening.

Even in close-range shooting, the lens maintains the flatness of the entire image plane to produce virtually distortion-free pictures.

Besides general telephoto photography, this lens is suited for portraiture, indoor sports, theatrical and landscape photography.

It also has a built-in telescopic lens hood.

Focal length:	135mm
Maximum aperture:	1 : 2.8
Lens construction:	4 elements in 4 groups
Picture angle:	18°
Distance scale:	Graduated both in meters and feet up to 1.5m and 5ft
Aperture scale:	f/2.8 – f/22
Aperture diaphragm:	Fully automatic
Meter coupling prong:	Integrated (fully open exposure metering)
Attachment size:	52mm (P=0.75)
Filter:	52mm screw-in
Lens hood:	Built-in telescopic type
Dimensions:	72.5mm dia. X 104mm length (2-27/32 in. X 4-3/32 in.)
Weight:	620g (21.9oz)
Accessories:	52mm snap-on front cap (108-00-400), rear cap type F (108-00-401), leather case (108-02-307), plastic case type L (108-02-300), flexible pouch No. 52 (108-02-302)

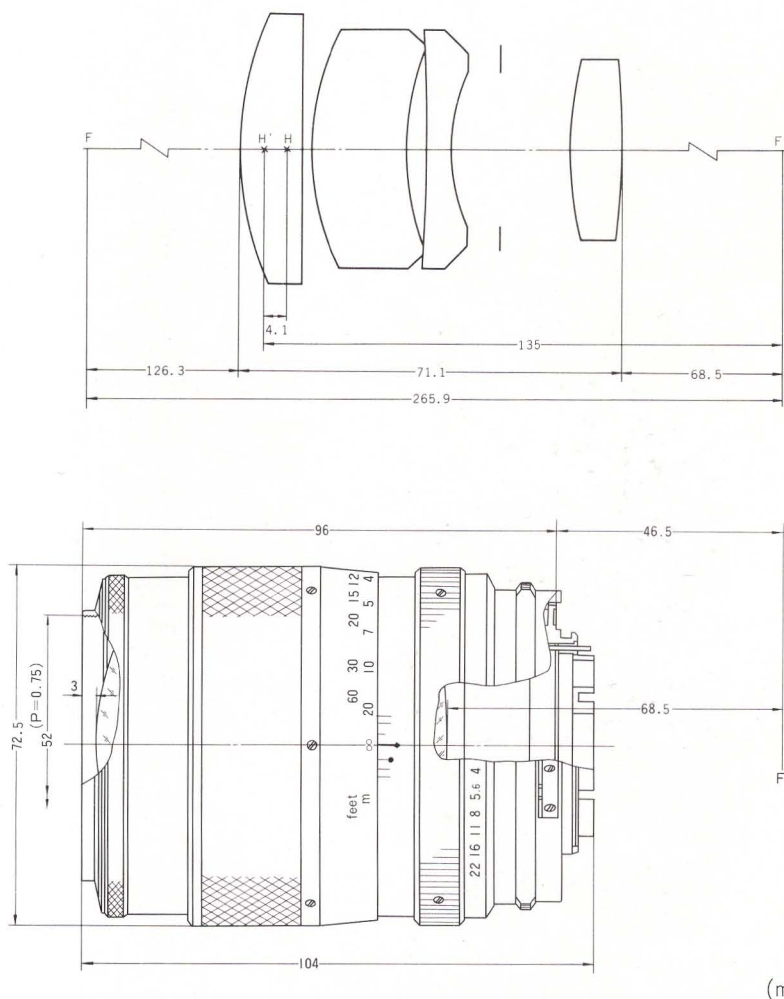

(mm)



Compact and lightweight, this is one of the most popular Nikkor telephoto lenses.

It consists of 4 elements in 3 groups. The lens barrel is comparatively short for its focal length—only 93.5mm. This telephoto weighs no more than 460g. Since it was “remodeled” in 1969, its performance, especially chromatic aberration at full opening, has been greatly improved, providing outstanding resolution over the entire picture field.

This all-round 135mm telephoto is a "must" for every photographer or serious amateur to achieve best results in snapshots, portraiture and landscape photography.

Focal length:	135mm
Maximum aperture:	1 : 3.5
Lens construction:	4 elements in 3 groups
Picture angle:	18°
Distance scale:	Graduated both in meters and feet up to 1.5m and 5ft
Aperture scale:	f/3.5 – f/32
Aperture diaphragm:	Fully automatic
Meter coupling prong:	Integrated (fully open exposure metering)
Attachment size:	52mm (P=0.75)
Filter:	52mm screw-in
Dimensions:	66mm dia. X 93.5mm length (2-19/32 in. X 3-11/16 in.)
Weight:	460g (16.2oz)
Accessories:	52mm snap-on front cap (108-00-400), rear cap type F (108-00-401), 52mm screw-in lens hood (108-02-200), 52mm snap-on lens hood (108-02-202), leather case (108-02-309), plastic case type L (108-02-300), flexible pouch No. 52 (108-02-302)

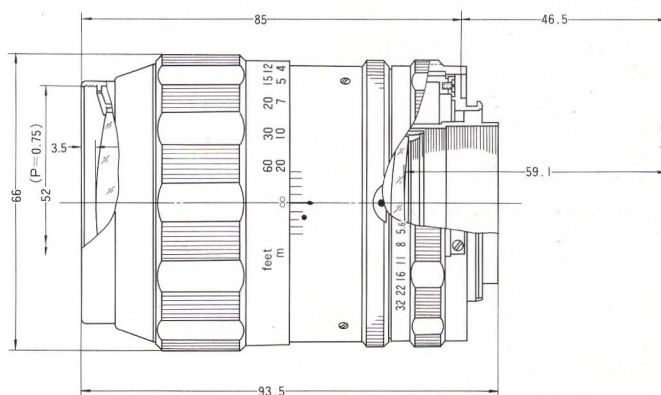
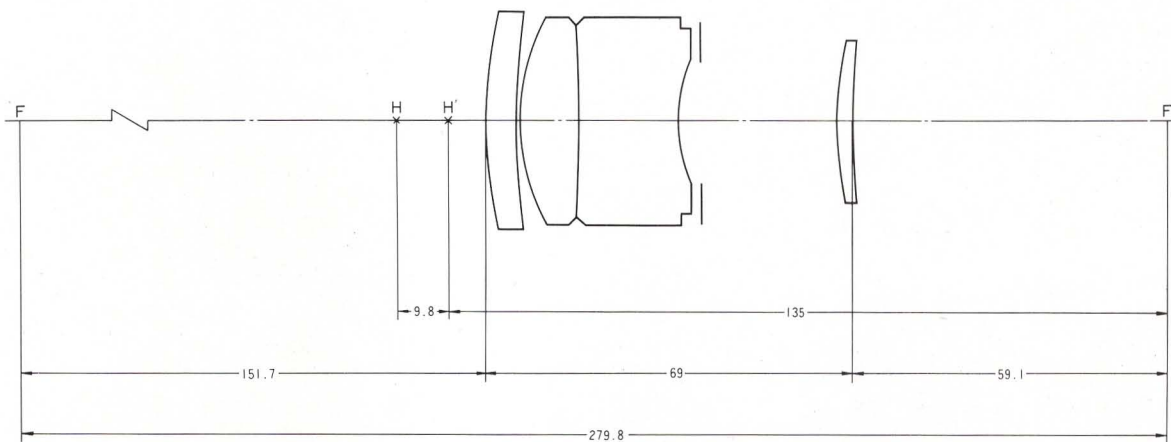

(m/m)

Its focal length, fully automatic diaphragm, lens speed and lightweight construction all add up to make this lens a priceless addition to the array of Nikkor telephoto lenses. Among the Nikkor lenses having the lens aperture of f/2.8, this lens has the longest focal length of 180mm. Even at full aperture, it forms very sharp images with high contrast. This lens is now indispensable for indoor sports, stage performances, etc. where the use of fast shutter speeds is required.

It is also useful for informal portraits especially in low light, moderate distance photography where the photographer must stand away from the subject. Outdoors or indoors, the 180mm lens shows exceptional performance in pinpointing and centralizing the subject.

Focal length:	180mm
Maximum aperture:	1 : 2.8
Lens construction:	5 elements in 4 groups
Picture angle:	13°40'
Distance scale:	Graduated both in meters and feet up to 1.8m and 6ft
Aperture scale:	f/2.8 — f/32
Meter coupling prong:	Integrated (fully open exposure metering)
Aperture diaphragm:	Fully automatic
Attachment size:	72mm (P=0.75)
Filter:	72mm screw-in
Lens hood:	Built-in telescopic type
Dimensions:	81mm dia. X 141mm length (3-3/16 in. X 5-9/16 in.)
Weight:	830g (29.3oz)
Accessories:	72mm screw-in front cap (108-02-400), rear cap type F (108-00-401), leather case CL-12 (108-02-314)

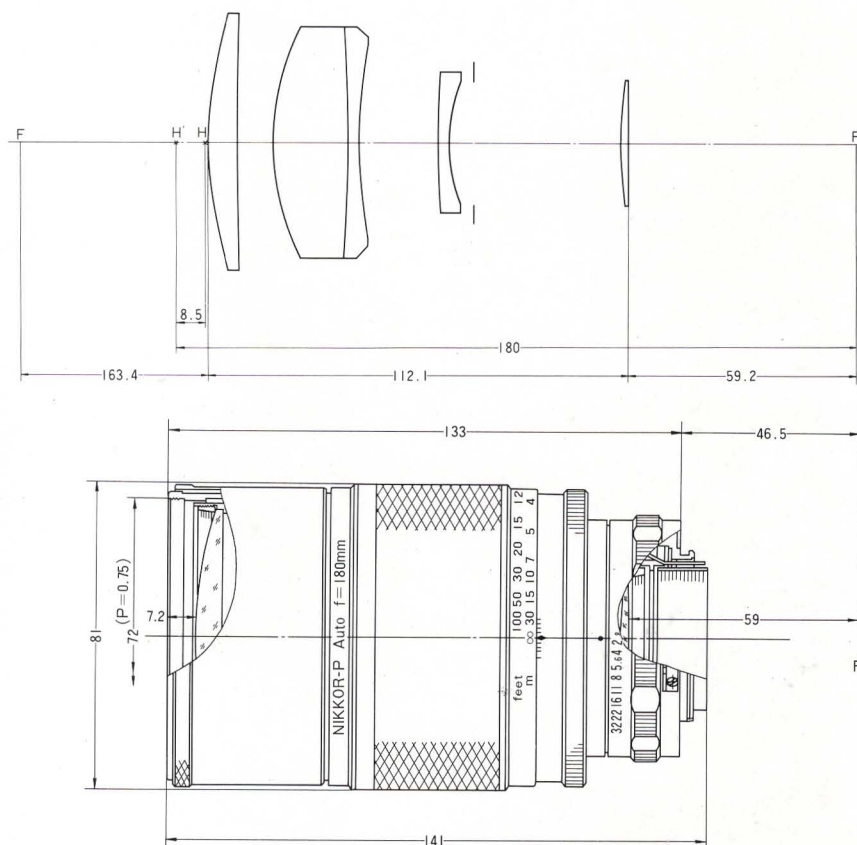

(m/m)



Since the debut of the Nikon F camera in 1959, the 200mm f/4 lens has become one of the most popular telephoto lenses and is considered "standard" equipment by most Nikon photographers.

This telephoto lens, developed in 1969, is the "remodeled" version of its predecessor and gives greatly improved optical performance, especially in color balance and resolving power.

It is of the telephoto type design, consisting of 4 elements in 4 groups and provides 4 times image magnification over the 50mm normal lens.

Compact and lightweight, this telephoto ensures easy and rapid hand-held shooting for action-packed subject matter—news, sports, animals, snapshots—and portraiture, landscape as well as general photography.

Focal length:	200mm
Maximum aperture:	1 : 4
Lens construction:	4 elements in 4 groups
Picture angle:	12°20'
Distance scale:	Graduated both in meters and feet up to 2m and 7ft
Aperture scale:	f/4 — f/32
Aperture diaphragm:	Fully automatic
Meter coupling prong:	Integrated (fully open exposure metering)
Attachment size:	52mm (P=0.75)
Filter:	52mm screw-in
Lens hood:	Built-in telescopic type
Dimensions:	72.5mm dia. X 163mm length (2-27/32 in. X 6-13/32 in.)
Accessories:	52mm snap-on front cap (108-00-400), rear cap type F (108-00-401), leather case (108-02-311), flexible pouch No. 53 (108-02-303)

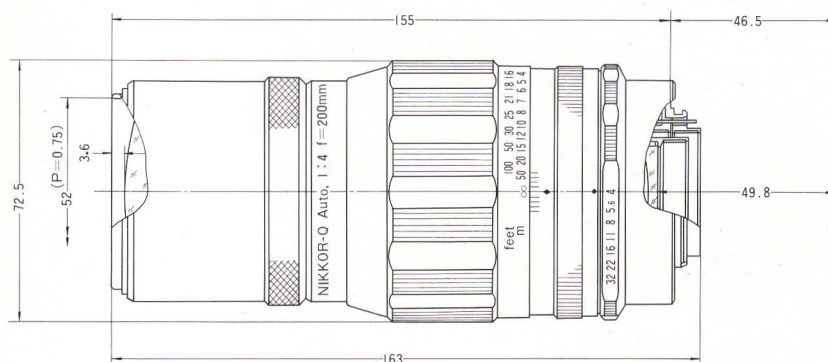
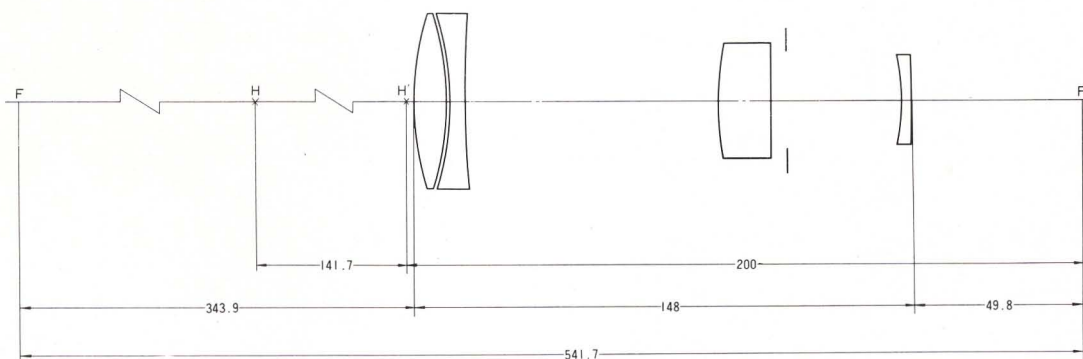

(m/m)

This is the "remodeled" version of the 300mm f/4.5 Nikkor-P Auto lens. Emphasis was placed on improving its overall optical performance, especially to maintain good color balance.

Despite its long 300mm focal length, this lens has a short barrel (about 200mm), is light in weight (about 1kg) and is considered to be the telephoto lens with the longest focal length that allows the average photographer hand-held shooting.

It features a fully automatic aperture diaphragm and a meter-coupling prong, and meets various requirements in action, sports and scenic photography. Complete with a built-in sliding telescopic lens hood and a tripod socket.

Focal length:	300mm
Maximum aperture:	1 : 4.5
Lens construction:	6 elements in 5 groups
Picture angle:	8°10'
Distance scale:	Graduated both in meters and feet up to 4m and 13ft
Aperture scale:	f/4.5 — f/22
Aperture diaphragm:	Fully automatic
Meter coupling prong:	Integrated (fully open exposure metering)
Attachment size:	72mm (P=0.75)
Filter:	72mm screw-in
Lens hood:	Built-in telescopic type
Dimensions:	80mm dia. X 203mm length (3-5/32 in. X 8 in.)
Weight:	1.1 kg (2.3 lb)
Accessories:	72mm screw-in front cap (108-02-400), rear cap type F (108-00-401), leather case (108-02-312)

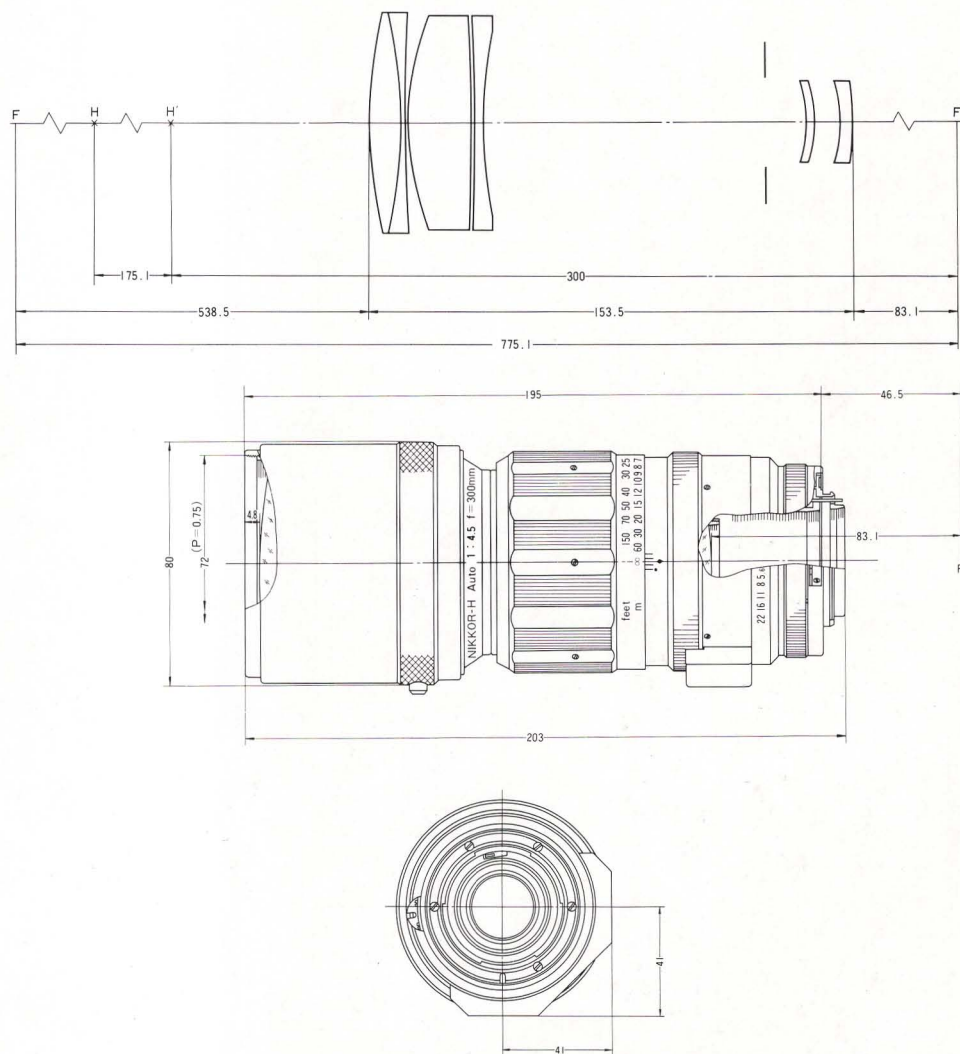

(m/m)