

THE MOTOR DRIVE GROUP

- Amazingly compact and lightweight
- Can be hand-held even with 300mm telephoto lens
- Advances film and cocks shutter *after* each exposure; always ready for action
- MOTOR DRIVE 1
 - freezes action as fast as five frames per second
 - adapts to all shutter speeds
- WINDER 1
 - .3 second per frame—more than 3 shots a second!
 - as fast as many motor drives

THE MOTOR DRIVE GROUP



Compact enough to permit hand-held shooting even with a 300mm lens and designed specifically to match the OM camera bodies, the Motor Drive Group has been reduced in size as part of the OM System basic concept. As a planned part of the system—and not an after-thought—this group benefits from miniaturization. It is extremely light and very easy to use. The combination of the Motor Drive 1 and M. 18v Control Grip is the smallest motor drive package in the world. The Motor Drive Group's versatility is further expanded when combined with accessories from other OM System groups.

There is no need to lock up the camera's mirror, even at 5 fps.

Both the OM-2 and OM-1 readily accept the Winder 1 and Motor Drive units.

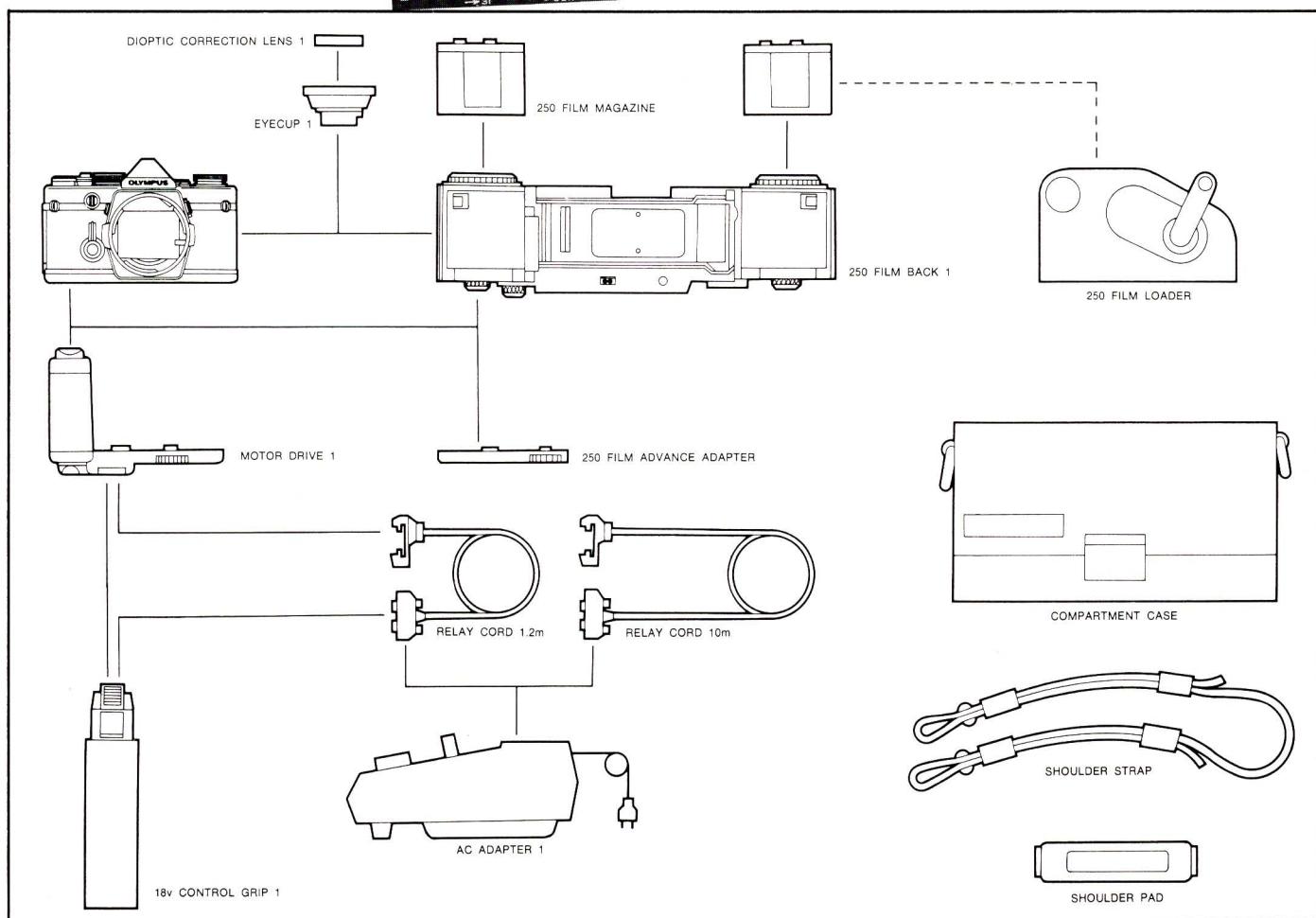
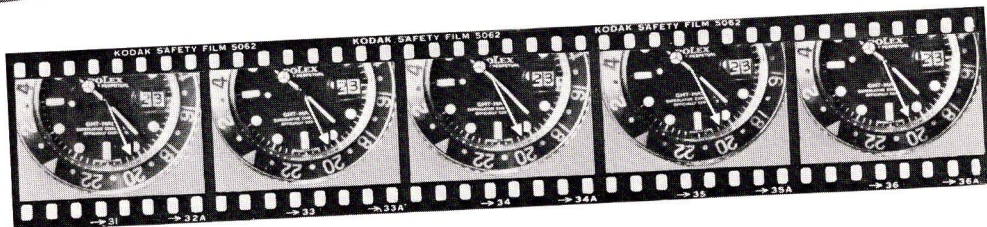



MOTOR DRIVE 1

Connects directly to OM-2 and OM-1 camera bodies via their tripod sockets. Speeds from single frame to 5 frames per second, without mirror "lock-up." Tough but light, weighing a mere 7.4 ounces. Attaches in the time it takes to change a lens. Wind-on time 0.16 second. Operates at any shutter speed except 1 second with OM-1 in SEQUENCE mode. DC, with Nicad (Control Pack, AA battery powered Control Grip 1, or AC with M.AC Control Box Adapter.

ORDERING INFORMATION

Motor Drive 1

Stock No. 106-010

OLYMPUS WINDER

Provides motor-driven single frame advance up to a speedy three frames per second. Advances film and cocks shutter *after* each exposure for faster operation. Four 1.5v AA batteries provide enough power for about 50 rolls of 36 exposure film. Compatible with OM-2 and OM-1 cameras.

ORDERING

INFORMATION

Olympus Winder

Stock No. 106-001

M-6 Volt Battery Holder for Winder (replacement)

Stock No. 106-002





250 FILM BACK 1

Can be quickly attached in place of the OM-2 or OM-1 rear cover. Allows the use of roll film for up to 250 exposures. Can be used with Motor Drive 1 or Winder 1. Sequential frame counter.

ORDERING INFORMATION

250 Film Back 1

Stock No. 106-040

RELAY CORDS

Extension cords for use with the M. AC Adapter 1 and the Motor Drive 1. Two lengths are available: 1.2m (3'11") long and 10m (32'9 3/4") long.

ORDERING INFORMATION

1.2m Relay Cord
Stock No. 106-030

10m Relay Cord
Stock No. 106-031



250 FILM MAGAZINE

Makes loading a 250 exposure roll of film into the 250 Film Back 1 convenient, quick and easy.

ORDERING INFORMATION

250 Film Magazine

Stock No. 106-041

M. 18v CONTROL GRIP 1 M. 18v BATTERY HOLDER 1

Pistol-grip type power pack for Motor Drive 1. Built-in release button for single frame or continuous exposures. 18v Control Grip 1 uses 12—1.5v No. 3 batteries.

ORDERING INFORMATION

**M. 18v Control Grip 1
(w/Battery Holder)**
Stock No. 106-020

**M. 18v Battery Holder 1
(replacement)**
Stock No. 106-021

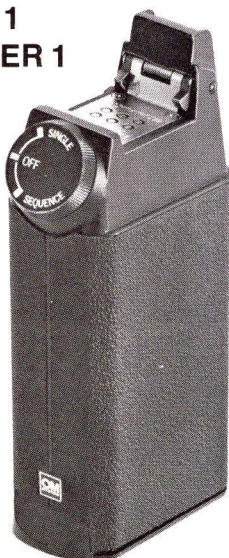

250 FILM LOADER

Winding equipment for convenient film loading into 250 Film Magazine.

ORDERING INFORMATION

250 Film Loader
Stock No. 106-042





M. AC CONTROL BOX 1

AC transformer element for use with Motor Drive 1 on household current. Incorporates selector switch between single-frame and sequential exposure operation, has terminals for relay cords and timer.

ORDERING INFORMATION

M. AC Control Box 1
Stock No. 106-023

EYECOUPLER

The Eyecoupler is required for mounting the Eyecup 1 on the camera. Also used with the OM cameras and the Varimagni Finder for photomicrography, it attaches between the camera and the Varimagni Finder, extending the Finder away from the camera for more convenient viewing.

ORDERING INFORMATION

Eyecoupler
Stock No. 108-501

M. 15v NI-CAD CHARGER 1

Used to recharge the M.15v Ni-Cad Control Pack 1 from ordinary household current.

ORDERING INFORMATION

M. 15v Ni-Cad Charger 1
Stock No. 106-061

M. 15v NI-CAD CONTROL PACK 1

A flat-type rechargeable power unit that attaches to the Motor Drive 1 unit in the same way as the M. 18v Control Grip 1, to give the smallest, lightest motor drive assembly in the world. The assembly has the same performance characteristics as the Control Grip 1

SPECIFICATIONS:

- **Battery:** Built-in Ni-Cad cells. Charging time: 4-5 hours for full charge
- **Capacity:** Approximately 40 rolls of 36-exposure film
- **Mode Selector:** SINGLE, SEQUENCE and OFF, lift-and-rotate dial setting
- **Battery checking:** 3-level checker lamp (LED)
- **Size:** 5.08x2.64x1.38 in. (129x67x35mm)
- **Weight:** 9.2 oz. (260g)

ORDERING INFORMATION

M. 15v Ni-Cad Control Pack 1
Stock No. 106-060



MOTOR DRIVE CAPS (Chrome or Black)

Each motor drive unit is sold with its own protective cap. Replacements come in chrome or black, to match the OM camera bodies.

ORDERING INFORMATION

**Motor Drive Cap
(Replacement, Chrome)**
Stock No. 106-070
**Motor Drive Cap
(Replacement, Black)**
Stock No. 106-071